





# Yale Digital Door Lock

Programming · Operating

Keep this manual safe for reference and future maintenance

---

***User Manual*** YDM2107 / YDM3107

※ The functions and design of this product can be changed without notice for quality improvement.

## **1 Specifications**

## **2 Identification of Product**

1. Front Body
2. Back Body

## **3 How to use**

1. Registering Card / Touch key
2. Registering security code
3. Locking the door from the outside
4. Unlocking the door from the outside
5. Locking the door from the inside
6. Unlocking the door from the inside
7. Automatic / Manual Lock Mode
8. Forced Lock Mode
9. Break-in / Damage Alarm
10. Heat Alarm
11. Volume control
12. Battery

## **4 Option**

1. Remote control module
2. Remote control

## **5 Caution / Note**

1. Emergency power supply
2. Lost key
3. Product malfunction
4. Mechanical key override

## Overview

1. Security code : Use any code number 4-12.
2. Touch key or Proximity card key.
3. Emergency mechanical key : can lock and unlock the door at anytime.
4. Automatic locking locks automatically after 7 seconds.
5. Anti-panic egress : For convenience and in case of emergency, the door automatically unlocked whenever the inner lever is used.
6. Backlit keypad : The keypad will illuminate when any buttons are pushed.
7. Volume control : volume of signals can be adjusted to suit the environment.
8. The lock features a one-touch lock/unlock system.
9. Power consumption : A power saving circuit ensures long battery life.
10. Damage alarm : This product incorporates an alarm system that can trigger a sensor when the lock is subject to attack or force.



## IMPORTANT SAFETY INSTRUCTION

Please read the following safety instructions to prevent any accident, property damage and inconvenience. Children should be well educated in the operation procedure before use. Keep this manual in a convenient place so that you can refer to it when necessary.



**Caution** must be followed to protect yourself and your property



**Note** explains product functions and features.

symbol



prohibited



must observe

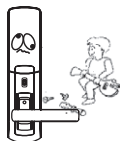

Do not attempt to dismantle or repair product. Please contact your nearest authorised service agent for any repairs or maintenance.

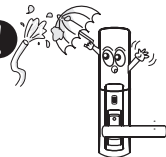

When cleaning use only a damp cloth to clean the lock body.

**Note** : Do not use any chemicals when cleaning.



This product may be damaged by impact.  
This could result in a malfunction.

# 1 Specifications

Parts		Specifications	Remarks
Front Body		72(W) x 304(H) x 75(D)mm	Input power : DC 6V Operating temperature : -15~55°C
Back Body		81(W) x 323(H) x 78(D)mm	High temperature alarm : 55°C
Keys		4 pcs	Up to 20keys (sold separately)
Battery		8 x 1.5V AA alkaline batteries	Last up to 1 year (based on 10 cycles per day)
Option	Remote control	wireless	Sold separately
	Remote control module	wireless	Sold separately

※ Battery life may vary depending on temperature, moisture levels, frequency of use and the quality of the batteries.

※ Please make sure that all parts are included when purchasing the product.

※ Optional products may not be available depending on your country or local dealer.

## ■ Basic contents

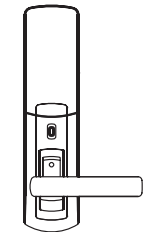

Front Body  
YDM2107

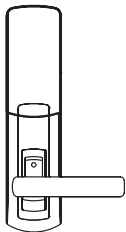

Front Body  
YDM3107



Back Body

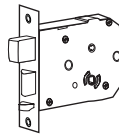

Mortise

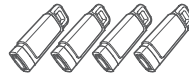

Touch keys  
YDM2107



Card keys  
YDM3107



Mechanical key

- User's manual
- Installation template
- Battery (8ea)

- Option
- Remote control
  - Remote control module

## 2 Identification of Product

### 1. Front Body - YDM2107

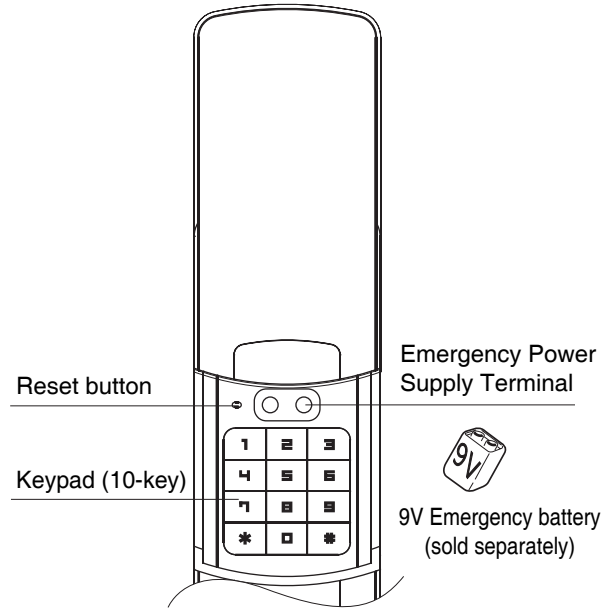
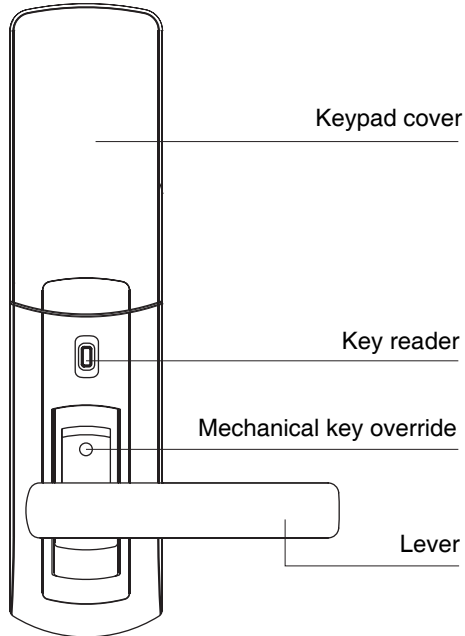

## 2 Identification of Product

### 1. Front Body - YDM3107

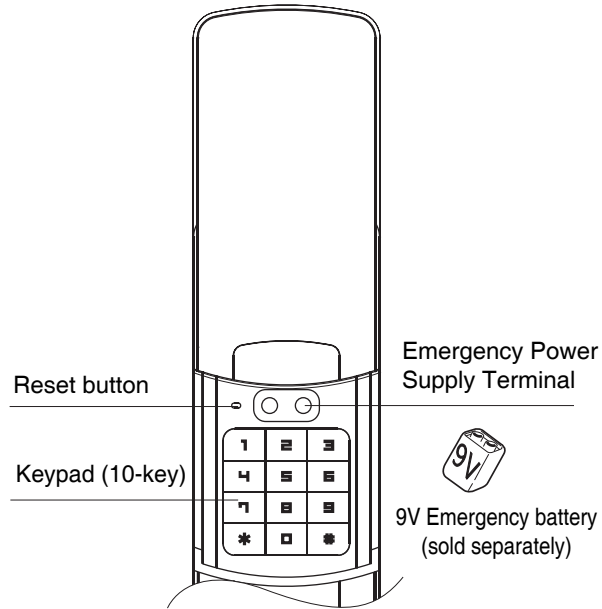
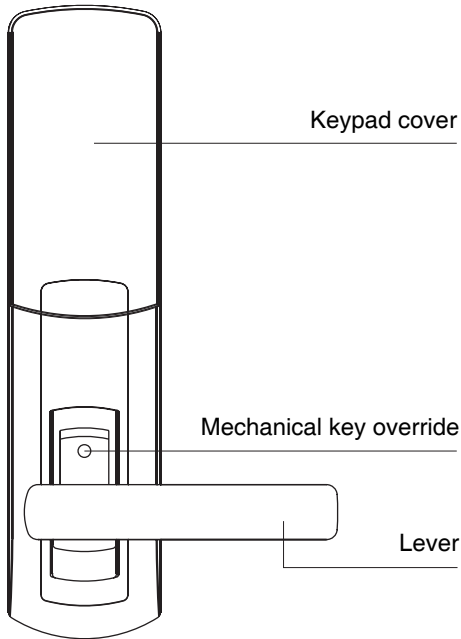



## 2 Identification of Product

### 2. Back Body - YDM2107 / YDM3107

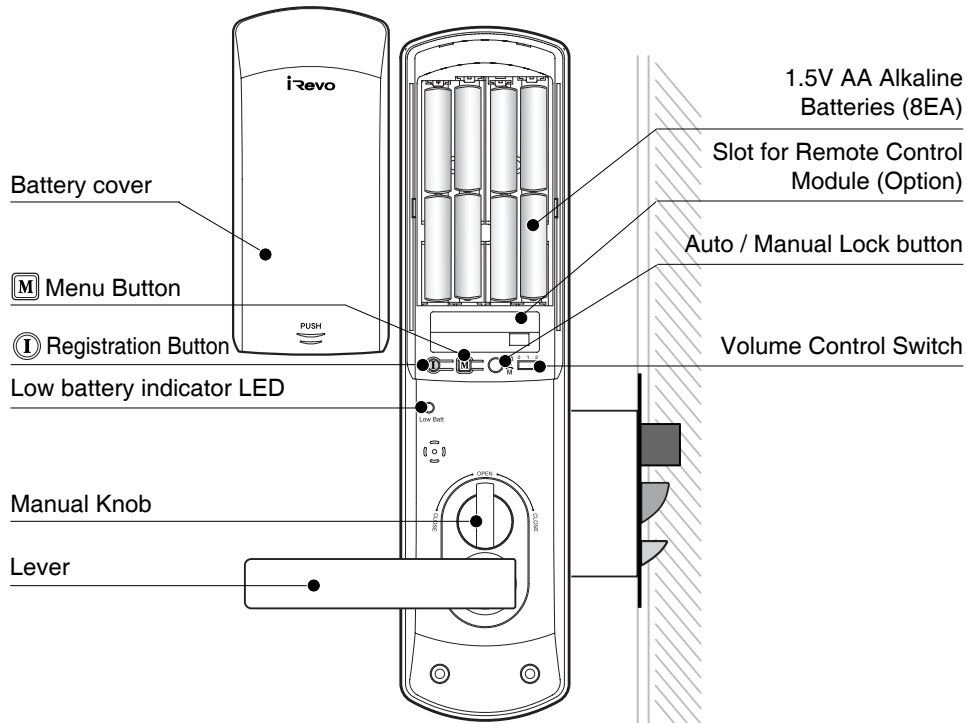

### 3 How to Use

#### 1. Registering Touch keys (YDM2107)

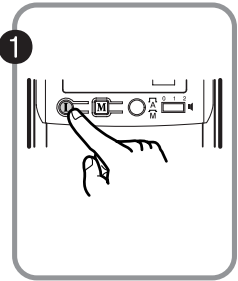
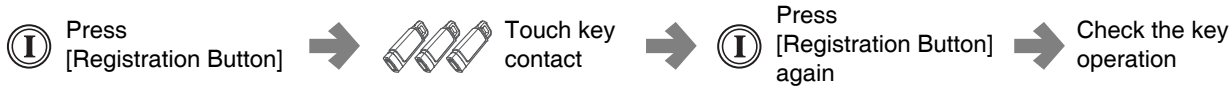

Open [Battery Cover] and Press ① Registration button

🔊 "BI-BING" sound

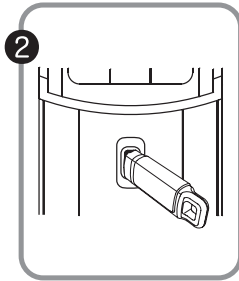

Contact all the  Touch keys you wish to register on the [Key reader] one by one

🔊 "BIK" sound

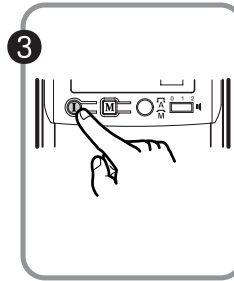

The ① registration is completed with a sound.

🔊 "BI-BI-BING" sound

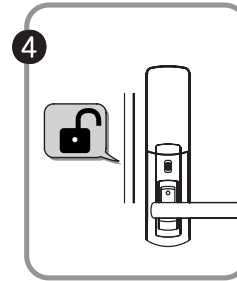

Opening the door with your Key. Contact your  Touch key to [Key reader]

### 3 How to Use

#### 1. Registering Card keys (YDM3107)

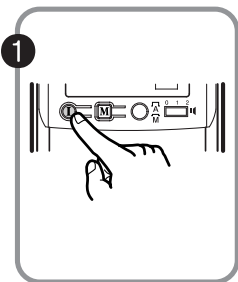

Open [Battery Cover] and Press  
① Registration button

🔊 "BI-BING" sound

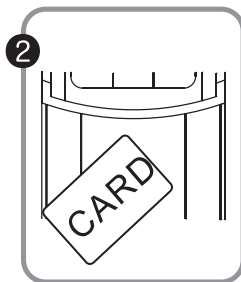

② Contact all the  Card keys you wish to register on the [Key reader] one by one

🔊 "BIK" sound

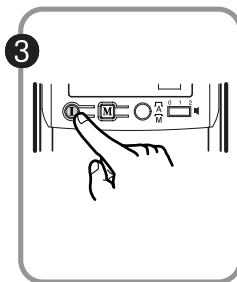

③ Press ① [Registration Button] again. The registration is completed with a sound.

🔊 "BI-BI-BING" sound

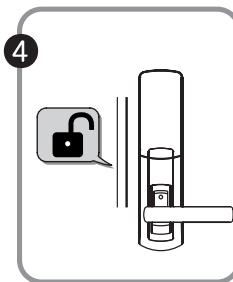

④ Opening the door with your Key. Contact your  Card key to [Key reader]

### 3 How to Use

#### 2. Registering Security Code

① Press [Registration] button → Enter your security code (4-12 digits) → ① Press [Registration] button again → Check the key operation

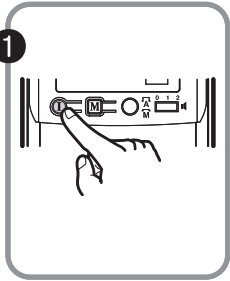

1 Open [Battery Cover] and Press ① [Registration] button.

🔊 "BI-BING" sound

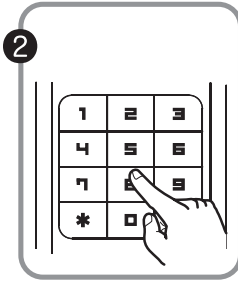

2 Open [Keypad cover] and enter your code you wish to register. (4-12 digits)

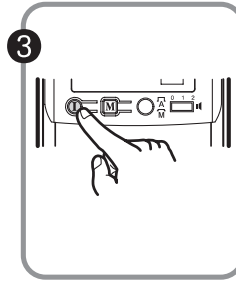

3 Press ① [Registration Button] again. The registration is completed with a sound.

🔊 "BI-BI-BING" sound

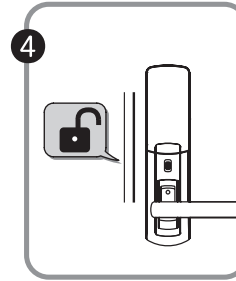

4 Once registration is completed, make it sure to open the lock with your new security code.



If it takes too long (over 20 seconds) to enter the code after pressing ① [register security code] button, the code will not be registered.



[\*] and [#] buttons can not be used for security codes.

### 3 How to Use

#### 3. Locking the door from Outside

Automatic lock mode

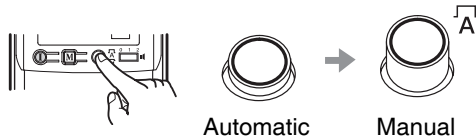

The automatic lock sensor detects the door closing and locks the door automatically within 5 seconds.

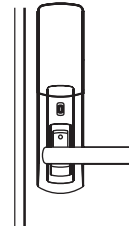

→  
Within 5 seconds

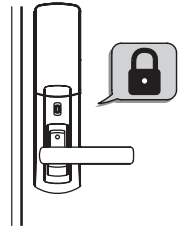

🔊 "BI-BI-BING" sound

Manual mode

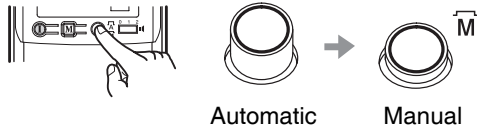

The door locks when you slide [Keypad Cover] up and back down again.

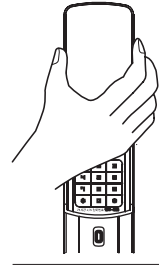

→

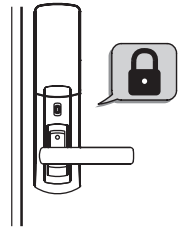

🔊 "BI-BI-BING" sound

#### Note

If the LED is not turned on slide up the [keypad cover] and press \* button to lock the door.

### 3 How to Use

#### 4. Unlocking the door from the Outside (YDM2107)

Unlocking the door with Touch key

Contact the Touch key on [Key reader]. After hearing "BI-BI-BING" sound, push the lever down to open the door.

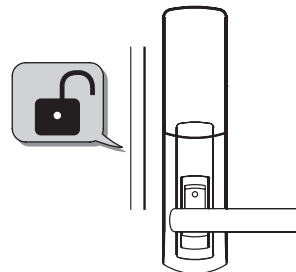
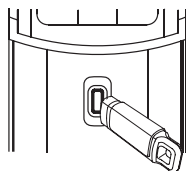

Unlocking the door with security code

Slide [Keypad cover] up. Enter your code and close down [keypad cover] to unlock the door. If the LED is not turned on with [keypad cover], press \* button to turn on the LED, enter your code and press button again or slide [keypad cover] down.

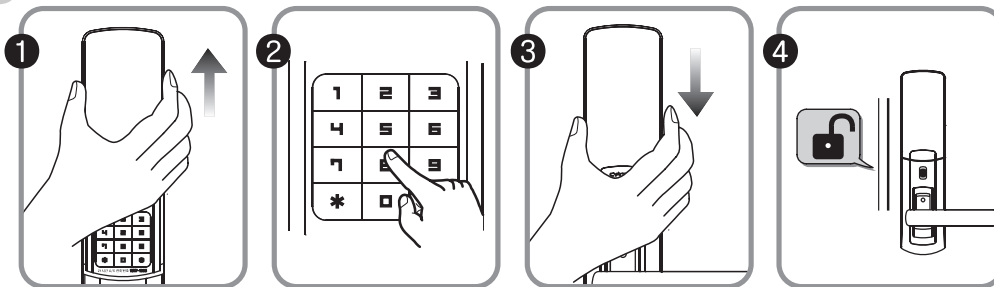

If incorrect codes or invalid Touch keys are entered 5 times, the lock is blocked out for about 3 minutes.

### 3 How to Use

#### 4. Unlocking the door from the Outside (YDM3107)

Unlocking the door with Card key

Contact the Card key on [Key reader]. After hearing "BI-BI-BING" sound, push the lever down to open the door.

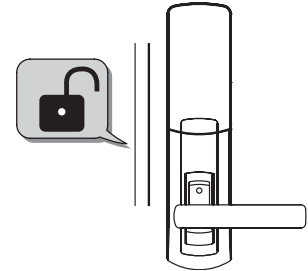
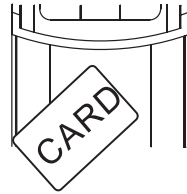

Unlocking the door with security code

Slide [Keypad cover] up. Enter your code and close down [keypad cover] to unlock the door. If the LED is not turned on with [keypad cover], press \* button to turn on the LED, enter your code and press button again or slide [keypad cover] down.

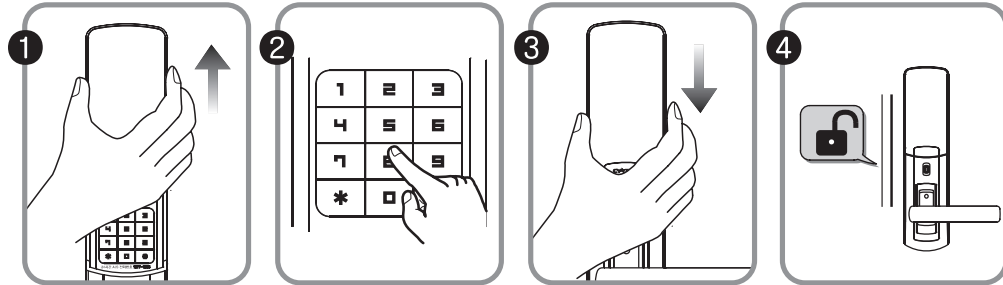

### 3 How to Use

#### 5. Locking the Door from the Inside

##### Automatic lock mode

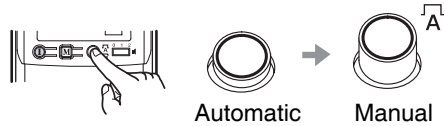

When set on automatic lock mode, the automatic lock sensor detects the door closing and locks the door automatically within 5 seconds.

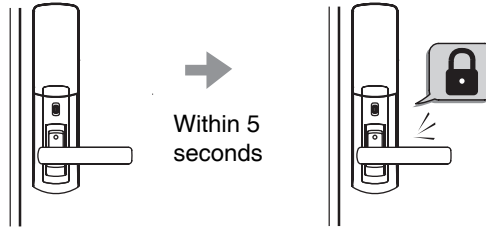

🔊 "BI-BI-BING" sound

##### Manual lock mode

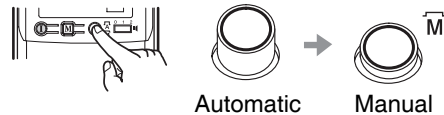

Use [Manual Knob] on the back body.

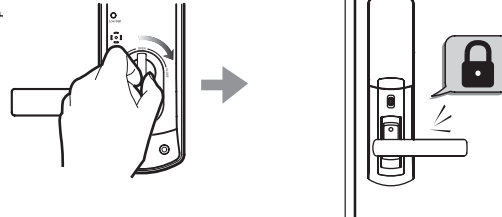

#### Note

This lock features anti-panic egress, which means that the door is automatically unlocked whenever the inner lever handle is used.



### 3 How to Use

#### 6. Unlocking the Door from the Inside

Manual knob or Lever

Turn the manual knob to open position or push down the lever on the Back Body.

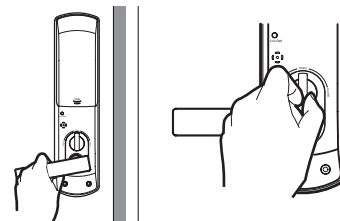

#### Note



This lock features anti-panic egress, which means that the door is automatically unlocked whenever the inner lever handle is used.

In case Lever doesn't work

Turn the manual knob to open position.

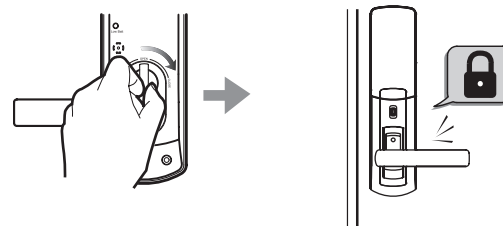

### 3 How to Use

#### 7. Automatic/Manual Lock Mode

Automatic locking sensor detects the door closing and automatically locks the door in 5 seconds. Automatic lock mode is a factory default setting.

Setting it on  
automatic lock  
mode

Push up the Button  
on **A** Mode.

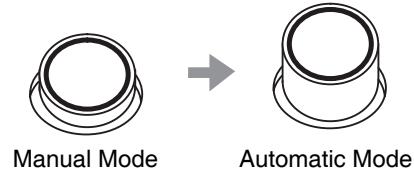
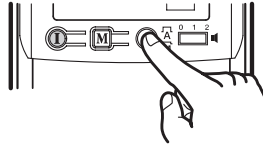

Setting it on  
manual lock  
mode

Push down the Button  
on **M** Mode

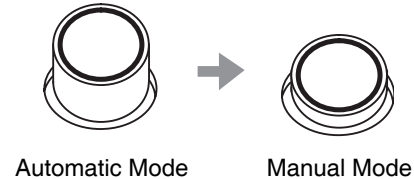
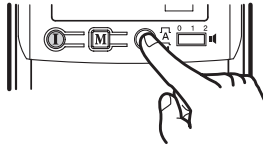

#### **Caution**

In case Manual lock mode, door will not lock automatically. Make sure to check the door when you go out.



### 3 How to Use

#### 8. Forced Lock Mode

The last person to leave the home can set the lock in externally forced lock mode. A burglar who enters through a window will then not be able to exit through the door without setting off an alarm.

Setting forced lock mode on with Key

Contact your Touch key or Card key on [Key reader] for 5 seconds until you hear 3 beeps.

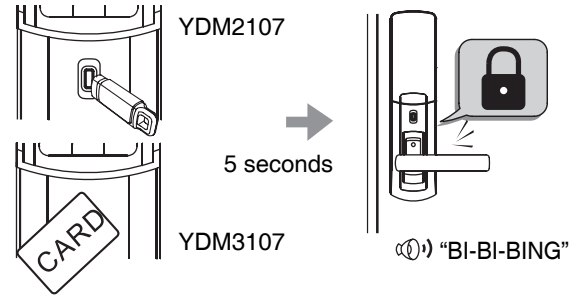

Locking with security code

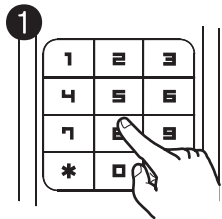

Slide up the [keypad cover] and enter your security code.

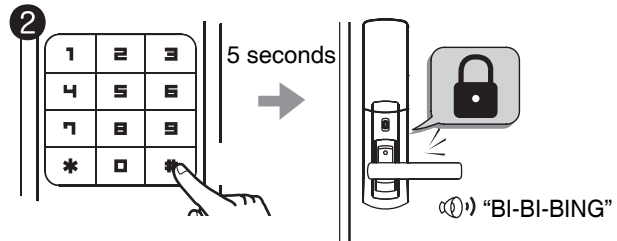

Press # button for 3 seconds until you hear 3 beeps.

### 3 How to Use

#### 9. Break-In/Damage Alarm

If the lock is damaged or entry is forced while the door is locked, an 80dB alarm is triggered. Turning off the alarm.

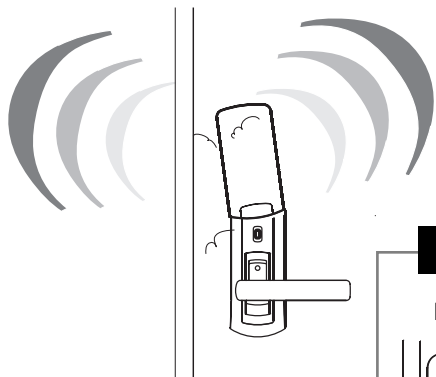

#### Caution



If the door didn't lock properly, alarm can ring.

#### Turning off the alarm

##### Method 1

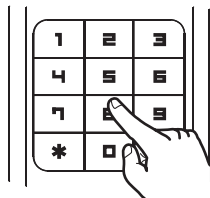

Enter your security code

##### Method 2

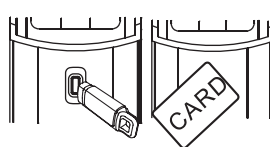

Contact your key on [key reader]

##### Method 3

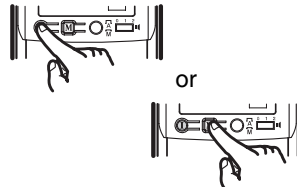

Press **I** or **M** button for 5 seconds

## 3 How to Use

### 10. Heat Alarm

#### ① What is heat alarm

If the lock detects the temperature as high as 60 degrees Celsius (140 degree Fahrenheit), it triggers the alarm and automatically unlocks. The detection temperature can be different depending on the installation circumstance.

#### ② Turning off the alarm

Enter your security code or Contact your key on [key reader] (See Break-in, Damage alarm off page) to turn off the alarm.

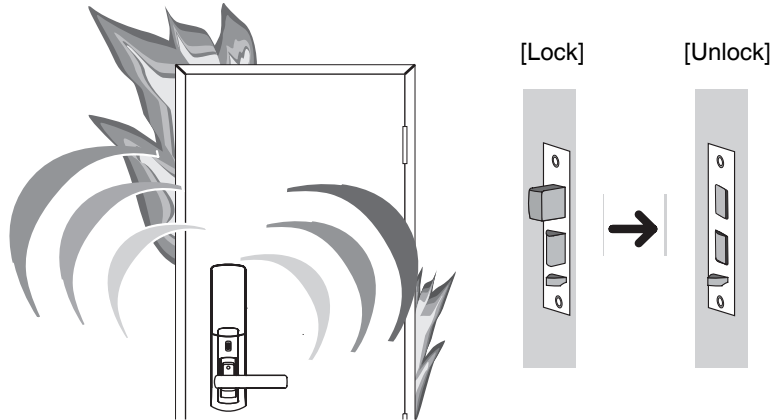

## 3 How to Use

### 11. Volume Control

This function controls the operating sounds so the lock can be used without any audible beeps.

#### 1 Mute

Set the Volume Button to “ 0 ”

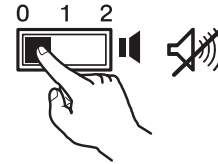

#### 2 Middle level

Set the Volume Button to “ 1 ”

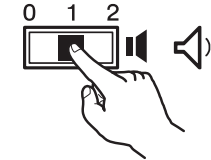

#### 3 High level

Set the Volume Button to “ 2 ”

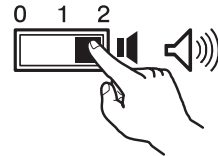

#### **Note**

In mute mode, the Error, Break-in, Damage and Heat alarms will still function.

### 3 How to Use

#### 12. Battery

##### ① Battery type

This product uses 8 1.5V alkaline AA batteries

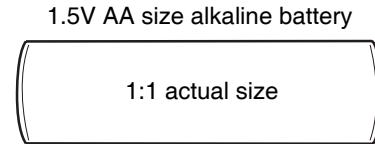

Input power : DC 6V

##### ② Battery replacement warning

Replace all 8 batteries when the low battery warning sound is heard and the LED turns red. (Use only alkaline batteries)

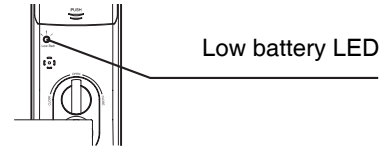

#### **Caution**

Always check the + and - directions when inserting batteries. Use only alkaline batteries.



## 4 Option

### 1. Remote Control Module

Remote Control Module should be installed in advance in order to use a Remote Control. Open [Battery Cover] and insert the module into the slot. Proper functioning of the module can be checked by operating a Remote Control .

Remote control module

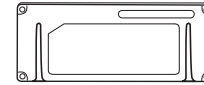

#### Installing Remote control module

1



2



3



4

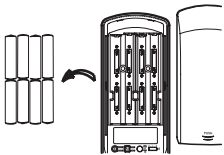

Open [battery cover] and remove all batteries.

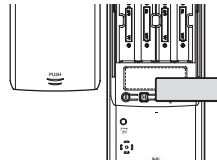

Insert remote control module into the slot

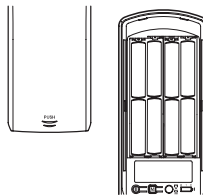

Put batteries back in (Check +, - directions)

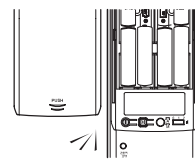

"DI-RI-RI-RING" sound

Confirming with the "DI-RI-RI-RING" sound



## 4 Option

### 2. Remote control

The Remote Control is FM frequency (FSK) type that uses Floating ID encoding system, which continuously changes the wireless code each time you use the Remote Control, so that there is no risk of hacking. It is non-directional and the operational range is up to 10-20m. The photo frame design allows you to create different atmospheres by putting in a photo and hanging the remote control on the wall.

#### Registering remote control



Press [Menu] button



Press 0,5 buttons



Press [registration] button located on the front of the remote control with a pin



Press the M button



Check remote control operation

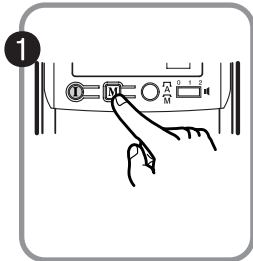

Open the [Battery cover] and Press  button.

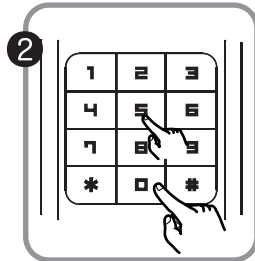

Open the [keypad cover] and press the 0 and 5 button on keypad.

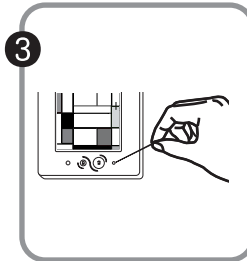

You can register up to 5 remote controls consecutively. In order to register consecutively, press the [Registration Button] on the Remote Control with 10 seconds intervals. Each Remote Control is registered with a beep.

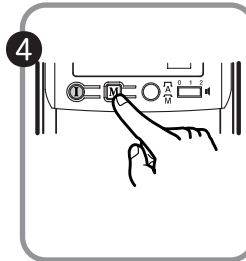

Press  button again.

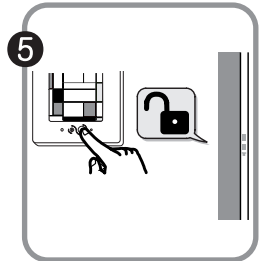

Press [open] or [close] button to check the operation.

## 4 Option

### 2. Deleting remote control

Press [menu] button

 Press [menu] button → Press 7, 5 buttons →  Press [menu] button → Deleting remote control registration

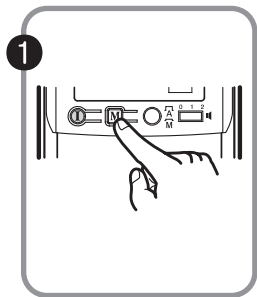

Open [Battery cover] and Press  button.

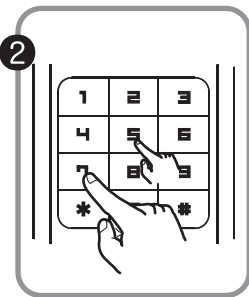

Press 7 then 5 button.

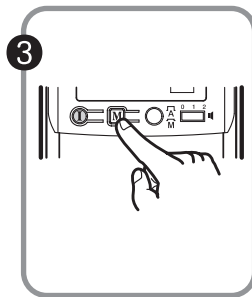

Press  [menu] button.

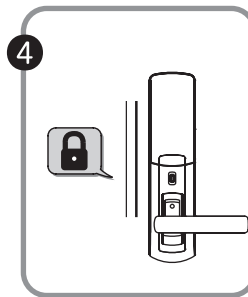

Remote control registration is cancelled with a sound.

## 5 Caution / Note

### 1. Emergency power supply

In case the batteries are completely discharged a 9V battery can be used to supply an electronic charge to the unit. Unlock with the Key or Security Code while contacting a 9V battery as illustration below. Discharged batteries should be replaced immediately.

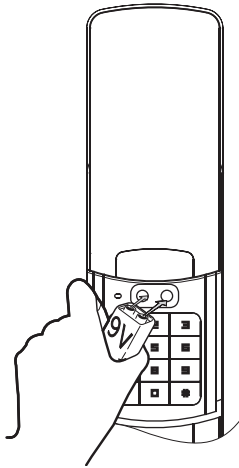

#### **Note**



Replace all 8 batteries at the same time.

## 5 Caution / Note

### 2. Lost key

If a key is lost you must re-register all other keys to deactivate the lost one. You should always keep a spare key handy to deactivate a lost registered one.

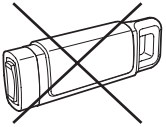

[lost key]

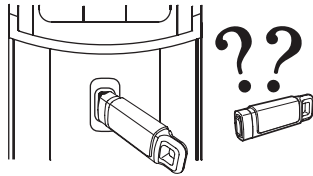

[Re-registering key]

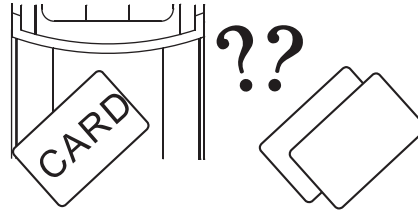

#### **Note**



Enter the Security code in case you misplace the key.

## 5 Caution / Note

### 3. Product malfunction

Should you experience any operating or programming problems you can reset the lock to its original factory setting as follows.

1. Press the Reset Button located in the left of [Emergency Power Supply Terminal ]with a pin.  
Then retry the desired function with the key or code.
2. Should you continue to experience any problems contact your nearest authorised service agent.

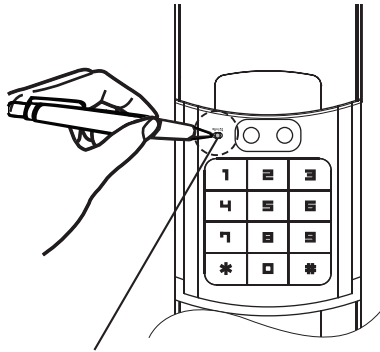

reset button

## 5 Caution / Note

### 4. Emergency mechanical key override

To lock or unlock the door use the emergency mechanical key.

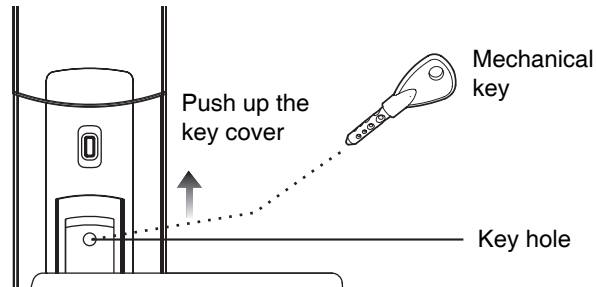

#### **Caution**



Keep the mechanical override key in a safe place.

MEMO